

# Solar borne installation notice

## List of delivered parts :

- 1 telescopic tube in anodised aluminium  
Ø 105 - 110 mm for pools 4 to 6 m wide
- 1 stand - motor side.
- 1 stand - free side
- 1 tubular motor - 24V
- 1 electric control panel
- 1 Key switch
- 1 bag including :
  - 8 nylon tees (10)
  - 8 stainless steel screws A4 8 x 40
  - 8 stainless steel washers A4 Ø8
  - 4 stainless steel screws TC M6 x 20 (motor)
  - 1 adjustment ring
- 4 screws M6 x 8
- 1 allen key (3)
- 1 key for the automatic stops
- 13 elastic straps
- 1 installation notice.
- 1 remote control - option

## Packing list

Stands : 1 box 0.80 m x 0.60 m x 0.45 m - 20 kg

Tube: 1 length 0.15 x 0.25 x 3.30 m - 15 KG

Total weight : 35 kg

One person is enough for the assembly

## Necessary tools

Screwdrivers (flat and philips), a driller (Ø10), n°13 spanner, a hammer.



The manufacturer is not responsible for damages happening during transport. Upon receipt of the delivery the recipient must report any damage. In any event the consignment must be checked within 48 hours of delivery and any damage or shortages reported immediately within the 48 hours.

READ CAREFULLY AND KEEP FOR LATER CONSULTATION.

# Installation

## 1 - Supports installation

Mark the location of screws on the ground.

Fix the supports with the screws provided.

Make sure that the stands are square to each other and to the pool.

Please Note: Maximum pool width is 6m

Straight radius

The centre line of the supports must be in line with the end of the pool copings.

Radius corners

The centre line of the supports must be on a line across the pool where the radius of the corners commence.

(to avoid any rubbing of the cover on the coping stones.)

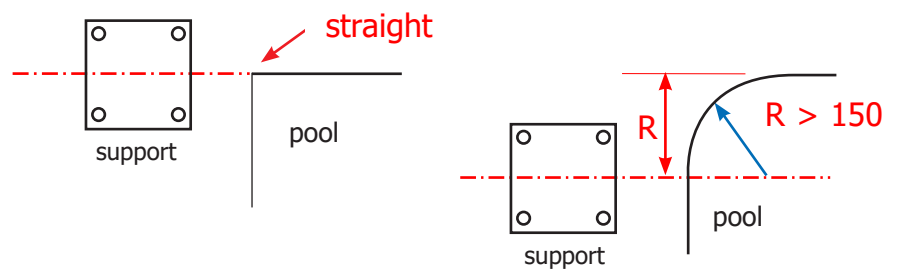
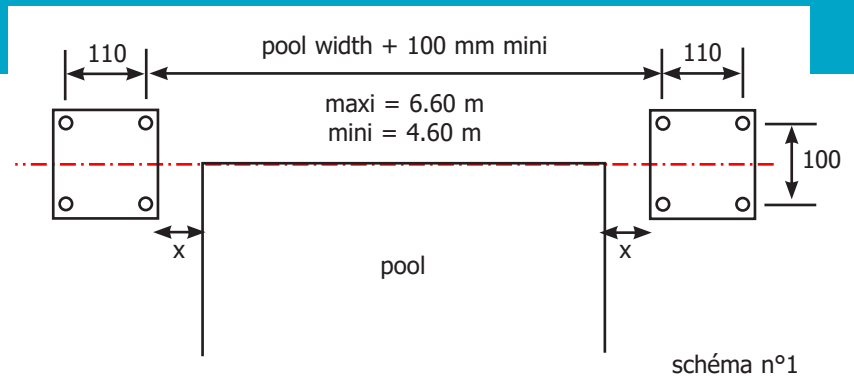

## 2 - Telescopic tube installation

Insert the tube axle into the free side support. (1)

Extend the tube to allow the motor end sit into the motor support bracket. (2)

Make sure the automatic stops are on top.

Ensure the 110mm middle tube section is sited precisely in the middle, and that the two ends of the tube are sited well into the motor and free side supports

Now tighten the four tube screws (3)

The electrical wire must go through the hole under the motor support.

- Close the supports with PVC nails. (4)

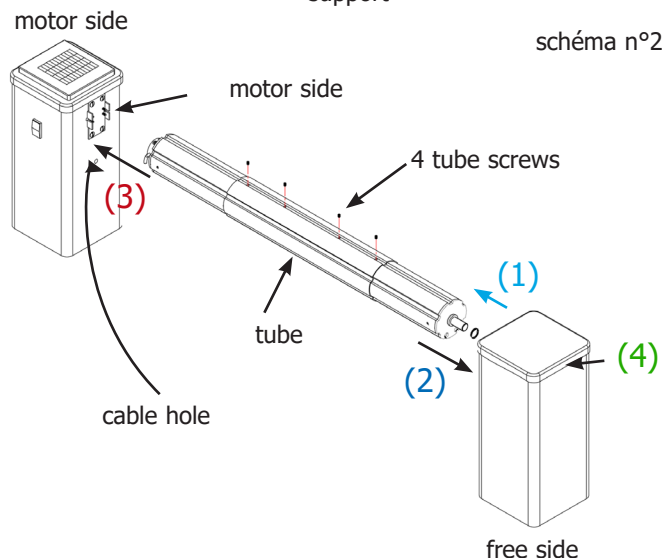

### 3 - Electrical installation

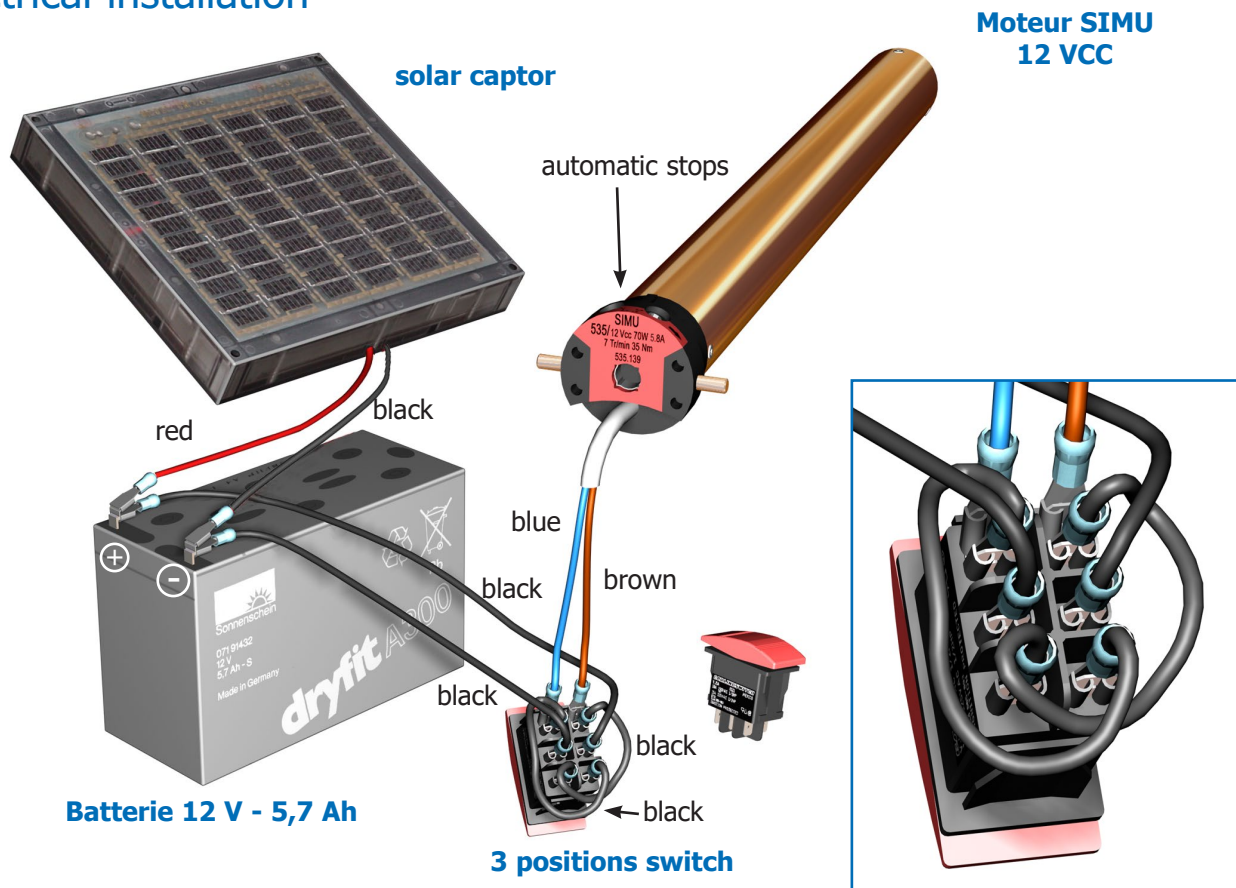

### 4 - Automatic stop adjustment

Automatic stops are located at the motor end.

Press on the red switch to open the cover on the pool.

When the motor stops, turn the automatic stop adjustment in the "+" direction until the pool is totally covered.

Attention : if the motor does not stop automatically, press the switch and adjust the automatic stops to get the desired position. When not in use always leave the switch in

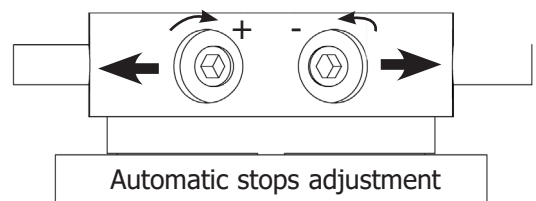

### 5 - Eclaté

- 1 - PVC cap with solar captore
- 2 - free PVC cap
- 3 - motor side pvc support
- 4 - pvc support free side
- 5 - motor side support plate
- 6 - free side installation plate
- 7 - battery support
- 8 - motro support
- 9 - Screws inox TRL M8 x 16
- 10 - washer inox Ø8
- 11 - Screws inox M8
- 12 - tubular motor SIMU 35 Nm
- 13 - Adaptor NT5
- 14 - T5 stop washer
- 15 - motor screw
- 16 - motor support
- 17 - bolt Ø3 x 20
- 18 - screw inox TC M5 x 20
- 19 - motor side unit
- 20 - PVC ball bearing Ø20
- 21 - shaft
- 22 - Screw inox TRL M8 x 30
- 23 - adjustment washer
- 24 - free side unit "with bolt"
- 25 - aluminium Rivet 4,8 x 17
- 26 - screw inox STHC M6 x 8

- 27 - side tube
- 28 - middle tube
- 29 - screws inox A4 8 x 40
- 30 - washer inox Ø8
- 31 - nylon tee delta 10
- 32 - switche 3 positions
- 33 - PVC

