

EN



# INSTALLATION GUIDELINES

INSTALLATION/SERVICING/MAINTENANCE/SAFETY ADVICE



DEL 

IN-GROUND POOL COVER

ROLLIN

---

# CONTENTS

## **PLEASE READ THESE INSTRUCTIONS CAREFULLY AND KEEP THEM FOR FUTURE REFERENCE**

Please read this manual carefully to help you understand all of the information and to ensure safe installation, use and servicing. We are not held liable for any damage arising due to a failure to respect the instructions set out in this manual.

DESCRIPTION.....	p. 4
Components provided .....	p. 4
Tools required for assembly.....	p. 6
Packing list .....	p. 6
Assembly .....	p. 6
INFORMATION.....	p. 6
Ensuring the cover complies with French standards .....	p. 7
INSTALLATION.....	p. 8
Pit .....	p. 8
Motor housing .....	p. 10
Installation of white goods .....	p. 10
Installing the motor side flange .....	p. 11
Installing the free side bearing .....	p. 11
Installation of the reel system .....	p. 12
Waterproofing on the motor housing side.....	p. 13
Installing the motor .....	p. 13
Beam support .....	p. 16
Installing the beam .....	p. 18
Middle telescopic support .....	p. 18
Installing the counterweights.....	p. 18
Installation of the counterweights.....	p. 19
Installing the decking.....	p. 19

# CONTENTS

Control box.....	p. 20
Wiring for AQUA1 control box with Wi-Key control .....	p. 21
Wiring for AQUA1 control box with key switch control .....	p. 22
Wiring for MIT 5210-7210 (DL motor) control box with Wi-Key control .....	p. 23
Wiring for MIT 5210-7210 (DL motor) control box with key switch .....	p. 24
Wiring for 6-pin connector – OPTION .....	p. 26
Wi-key control .....	p. 27
Calibrating limit switches (MCA120 - MCA250 motor).....	p. 30
Automatic switch (MCA120 - MCA250 motor) .....	p. 33
Verification of control logic for automatic switch .....	p. 34
Rewinder model calibration (Settings switch) .....	p. 35
Control period calibration (Settings switch).....	p. 35
Triggering sensitivity calibration (Prog switch) .....	p. 35
Activation (Prog switch) .....	p. 35
Important .....	p. 36
Testing.....	p. 36
Calibration of limit switches (MIT5210 - MIT7210 MOTOR).....	p. 37
<b>SERVICING/MAINTENANCE.....</b>	<b>p. 38</b>
Water level in pool.....	p. 38
Water filtration & treatment.....	p. 38
Servicing (customer’s responsibility) .....	p. 38
Maintenance .....	p. 39
Wintering.....	p. 39
Wintering lever (option) .....	p. 40
<b>SAFETY ADVICE AND STANDARDS .....</b>	<b>p. 41</b>
<b>RECYCLING .....</b>	<b>p. 43</b>

# DESCRIPTION

## COMPONENTS PROVIDED

### WHITE GOODS

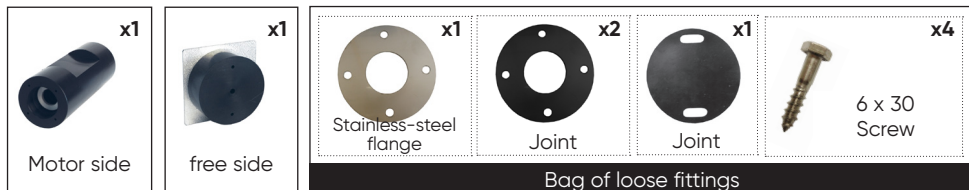

### INSTALLATION KIT

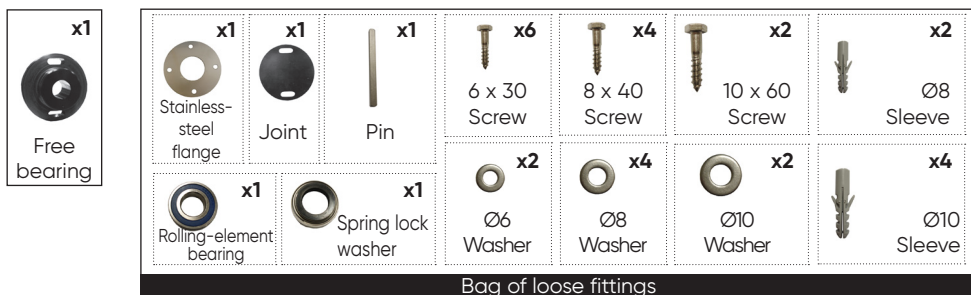

### GEARED MOTOR WITH BRACKETS

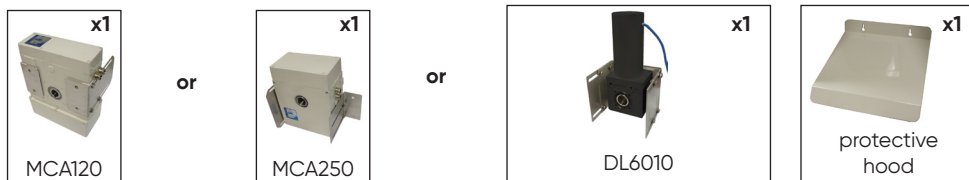

### CONTROL BOX AND COVER CONTROL

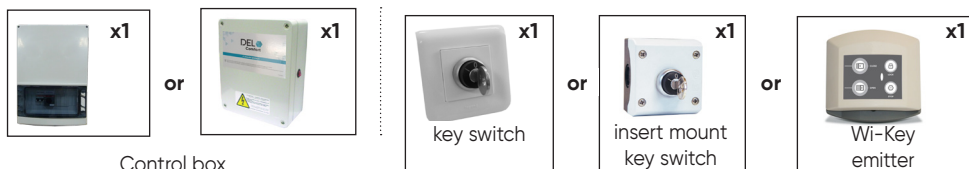



# DESCRIPTION

## COUNTERWEIGHTS



Counterweight  
Quantity variable  
depending on width  
of pool

## REEL SYSTEM



x1  
Allen key  
male No. 4

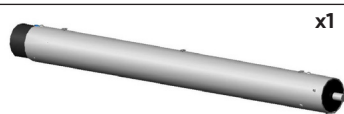

x1  
Anodised aluminium reel system

## BEAM SUPPORTS – Model and colour according to order (1 Packing)



Pegged  
façade

or



Adjustable  
hanging mount

or

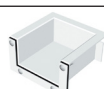

insert mount

## BEAM – Model according to order (1 Packing)

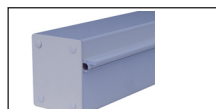

For beam hanging  
mount or pegged  
Beam support

or



For insert mount  
supports

## MIDDLE TELESCOPIC SUPPORT (1 Packing)



OPTION

(for pools > 6m wide)

## DECKING – Model according to order (1 pallet)



IPE



Aluminium

## DESCRIPTION

### TOOLS REQUIRED FOR ASSEMBLY



### PACKING LIST

#### Example – for a 5.00 x 10.00m pool with roman stairs

Deck + Plates+control box: 1 0.65 x 0.45 x 0.25/40kg Packing

Reel system with motor: 1 0.15 x 0.15 x 5.10 m/40kg Packing

Beam: 1 0.15 x 0.15 x 5.10m/34kg Packing

Beam support: 1 0.30 x 0.20 x 0.20m/10kg Packing

Decking: 11.20 x 1.00 x 0.50m/100kg pallet

**Total weight: 224kg**

### ASSEMBLY



**2 persons**



**3 hours**

## INFORMATION

For swimming pools made of concrete, aerated concrete, solid or hollow masonry.

Pool open: the cover is rolled up into the pit that is covered with the decking. These rest on a beam that is fitted into Beam supports that need insert mount; hanging mounts or pegged brackets may also be used.

The shaft for the cover is Tubular at a depth of 55cm below the top surface of the pool.

Power is supplied by an control box located in a technical room.

The geared motor is located outside of the pool in a dry and aerated box (with water evacuation).

Limit switches can be set on the motor or directly on the control box depending on the model.

Opening and closing control is carried out via a switch located in a place from where the pool can be seen.

The cover is made of articulated waterproof slats that float on the surface of the water.

# INFORMATION

## ENSURING THE COVER COMPLIES WITH FRENCH STANDARDS NF P90-308

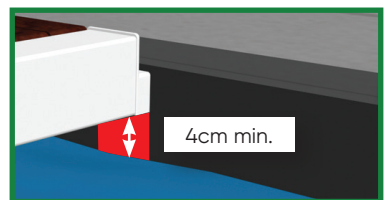
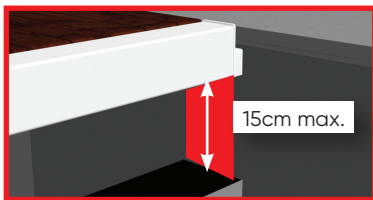
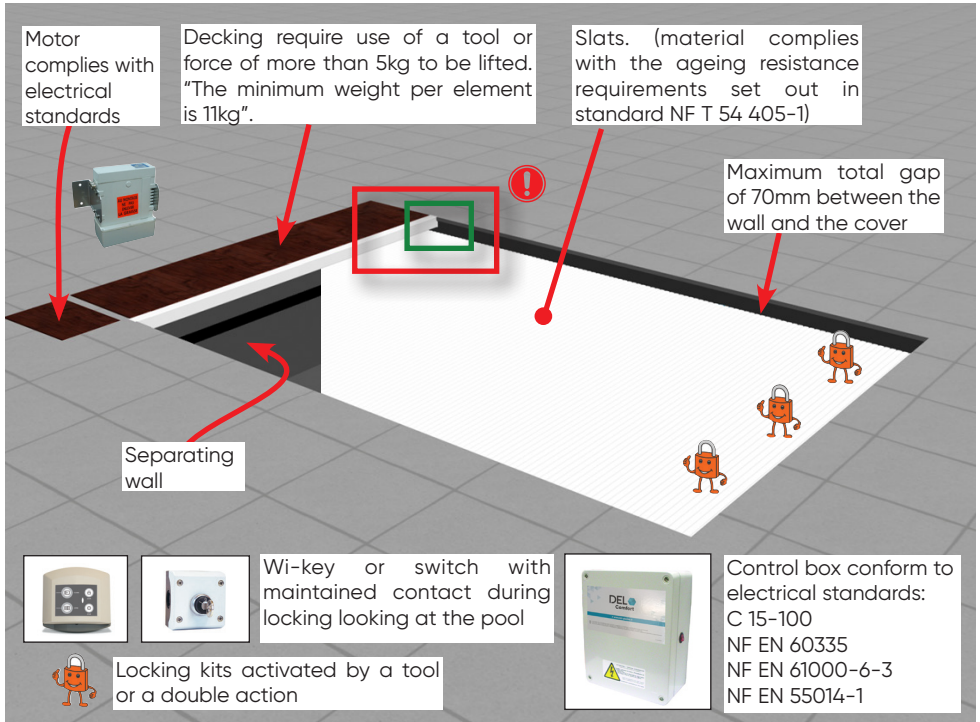

- On infinity pools, DEL covers are not compatible unless the pool is equipped with a Viatalia INFINITY control box to automatically lower the water level by at least 2cm when the cover is closed over the pool.
- currently, DEL covers including an adjustable fitting to go over a ladder on the side of the pool do not comply with standard NF P90-308.
- Unless the alarm manufacturer indicates otherwise, immersion alarms are not compatible with DEL covers.

# INSTALLATION

## PIT

**!** The walls of the housing must be vertical and parallel with each other.

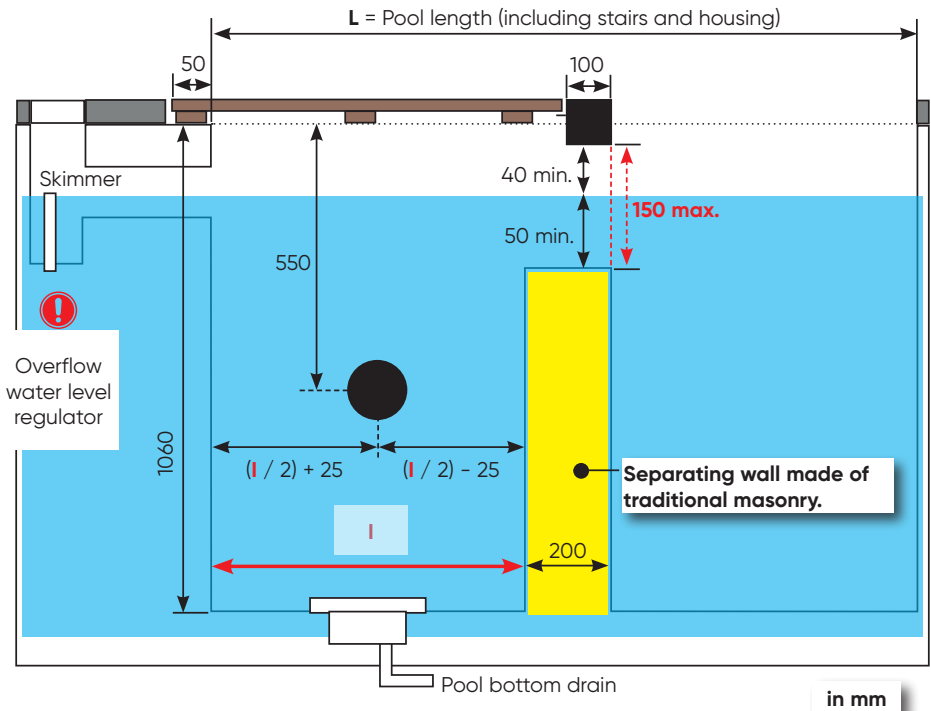

# INSTALLATION

<b>L</b> (in m)	< 6	6 to 7	<b>7 to 8</b>	8 to 9	9 to 10	10 to 11	11 to 12	12 to 13	13 to 14	14 to 15	<b>15 to 16</b>	16 to 17
<b>I</b> (in mm)	548	574	<b>600</b>	621	643	664	684	703	722	740	<b>750</b>	775

Decking  
750mm

Decking  
900mm

<b>L</b> (in m)	17 to 18	18 to 19	19 to 20	20 to 21	21 to 22	22 to 23	23 to 24	24 to 25	25 to 26	26 to 27	27 to 28	28 to 30
<b>I</b> (in mm)	791	807	823	839	854	869	883	897	911	925	938	965

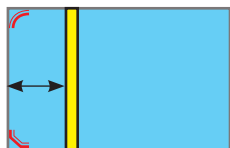

With right angles or shelves and cut-off corners  $\leq 10\text{cm}$  behind the pit.

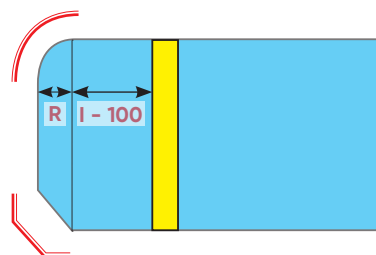

With shelves or cut-off corners  $> 10\text{cm}$  behind the pit.



The I dimension (minimum internal dimension of the pit) must be taken from the edge of the shelf or cut-off corner.

# INSTALLATION

## MOTOR HOUSING

**!** The motor housing can be placed to the right or the left of the pool.

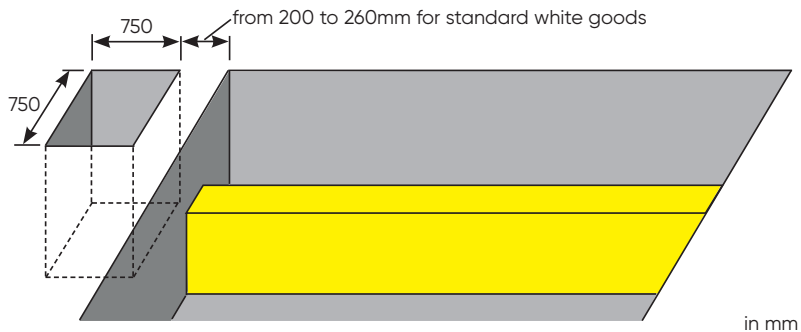

## INSTALLATION OF WHITE GOODS

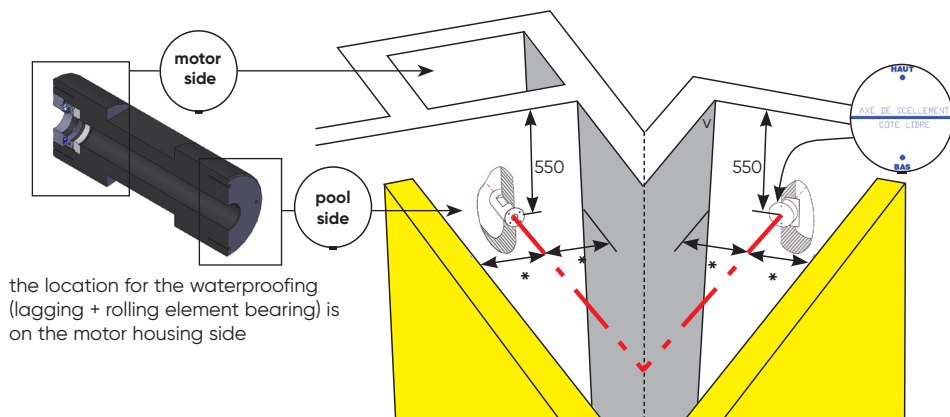

\* see page 8 in mm

**!** The "screw-in" part of the white goods must be embedded until it is flush with the finishing layer.

# INSTALLATION

## INSTALLING THE MOTOR SIDE FLANGE

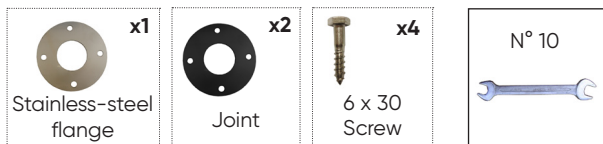

 **For any other type of waterproofing, do not use joint No. 1**

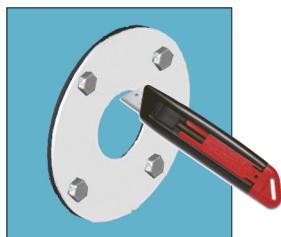
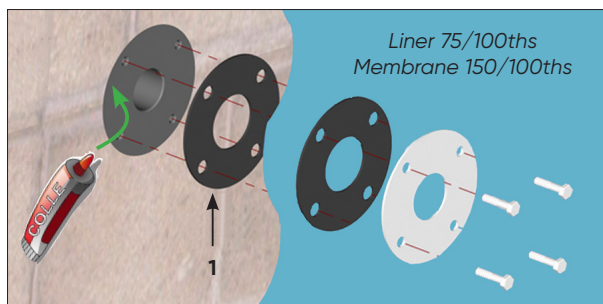

- Prime (around 20cm) before fastening the flange.
- Pierce the liner with an awl before bolting in.

## INSTALLING THE FREE SIDE BEARING



 **For any other type of waterproofing, do not use joint No. 1**



- Prime (around 20cm) before attaching the flange.
- Pierce the liner with an awl before bolting in.

# INSTALLATION

## INSTALLATION OF THE REEL SYSTEM

 Allen key male No. 4	x1	 M6 switch head bolts x 30	x5	 Ø6 PVC washer	x5	 Spacers	x5
Bag of loose fittings							

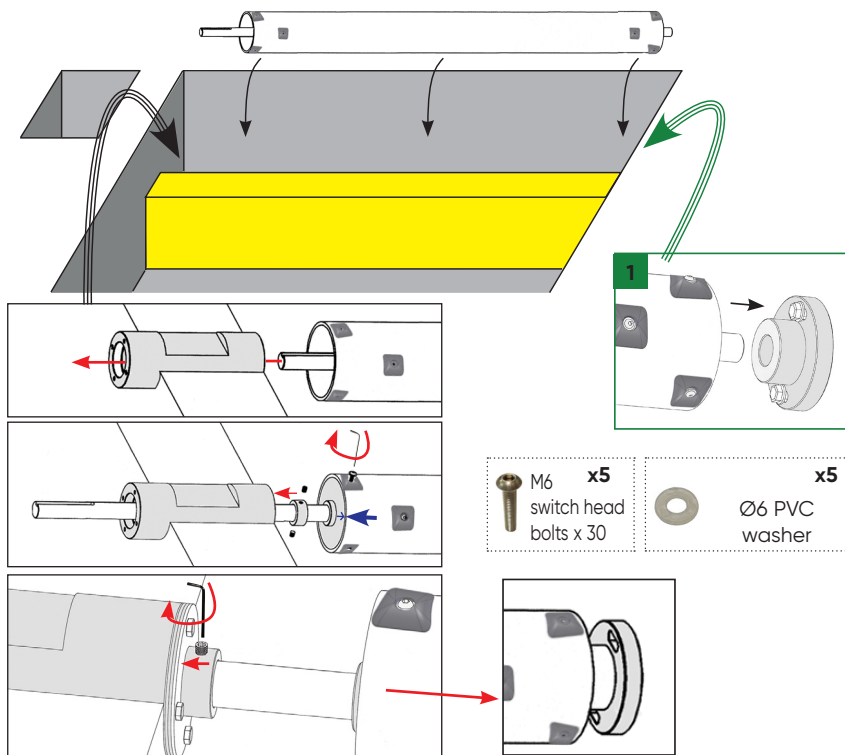
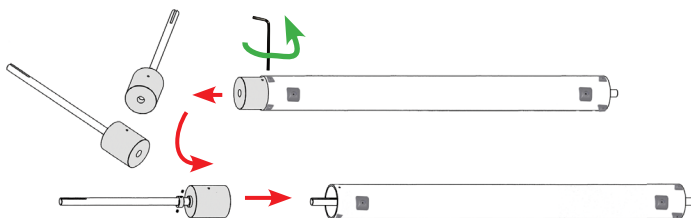



# INSTALLATION

## MOTOR HOUSING SIDE WATERPROOFING

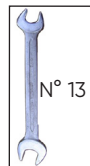

- The spring needs to rest against the rolling-element bearing
- Grease the stainless-steel axis in order to put the rolling-element bearing on
- Remove protective cap to pass shaft through spring

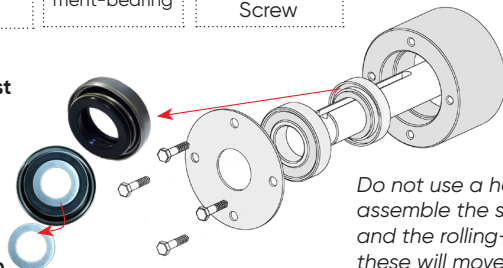

*Do not use a hammer to assemble the spring washer and the rolling-element bearing, these will move into place when the flange is tightened*

## INSTALLING THE MOTOR



**Test the motor before launching.**

## TURNING THE MOTOR BRACKETS

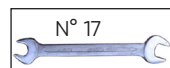

MCA120



MCA250



DL6010/7710



# INSTALLATION

## ▶ INSTALLING THE MOTOR



MCA120

MCA250



DL6010/7710

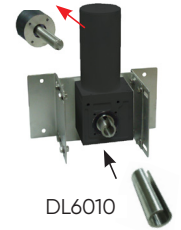

## ▶ FASTENING



MCA120

MCA250

DL6010/7710

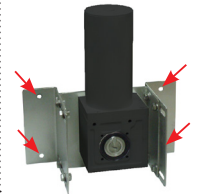
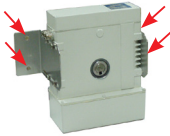

## ▶ INSTALLING THE PIN

MCA120

MCA250

DL6010/7710



# INSTALLATION

## ▶ INSTALLING THE PROTECTIVE HOOD FOR THE MOTOR



MCA120



MCA250



DL6010/7710



Option: 6-pin connector "page 25"

# INSTALLATION

## BEAM SUPPORT

### ADJUSTABLE HANGING MOUNT VERSION

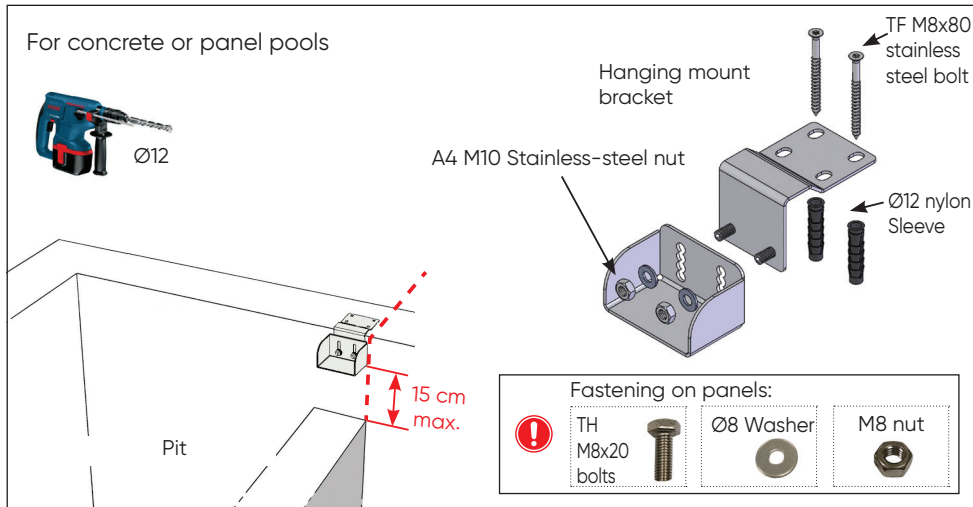

### VERSION THAT NEEDS INSERT MOUNT

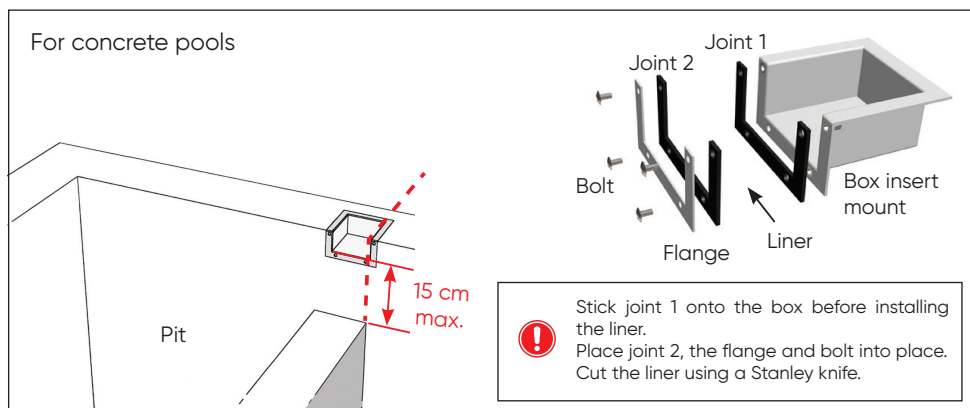

# INSTALLATION

## PEGGED FAÇADE VERSION

For pools made of concrete and concrete blocks, as well as for pools whose walls are 8mm thick or more

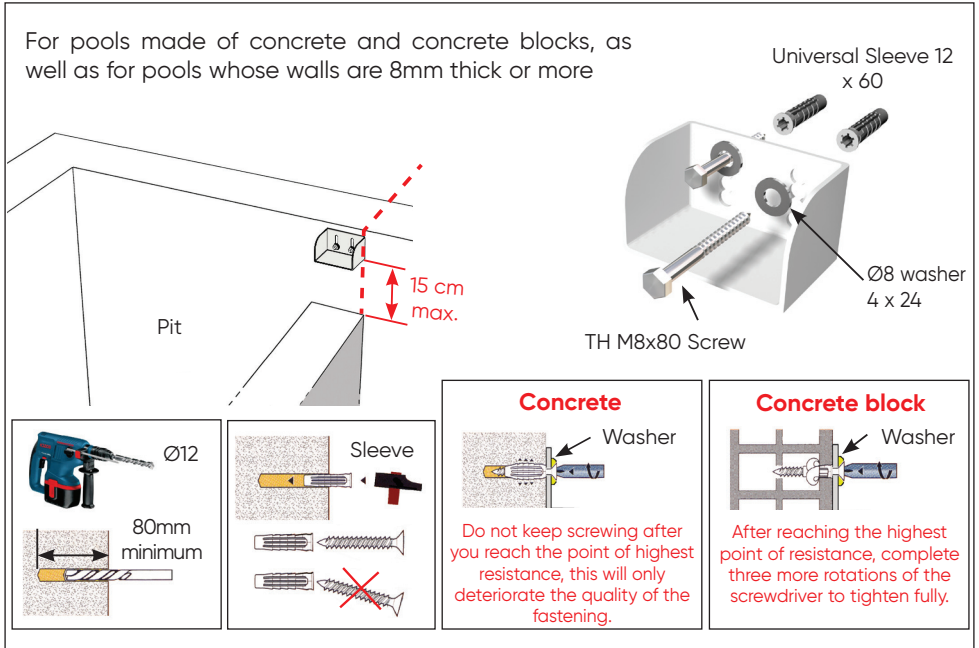

# INSTALLATION

## INSTALLING THE BEAM

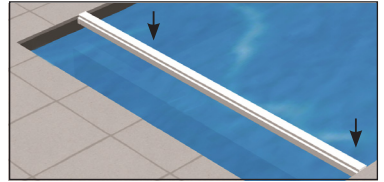
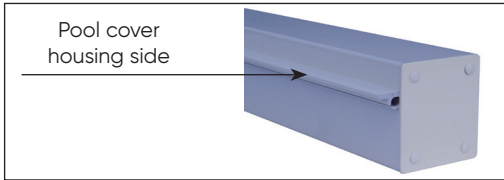

## MIDDLE TELESCOPIC SUPPORT

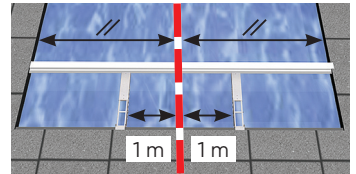
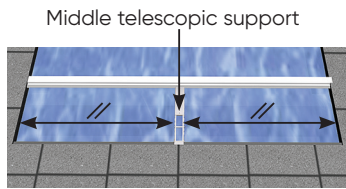
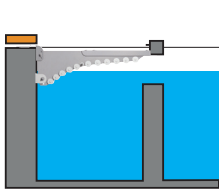

For pools that are more than 6m wide, remember to install 1 or 2 intermediate Beam supports in order to support the centre of the beam (see enclosed leaflet).

## INSTALLING THE COUNTERWEIGHTS

The counterweights ensure that the cover is rolled up correctly by "holding" it against the axis. Lateral movement of the counterweights allows "correction" of any uneven rewinding of the cover relative to the centre of the pool. The stair counterweight holds the stairs in place, so they do not fall backwards.

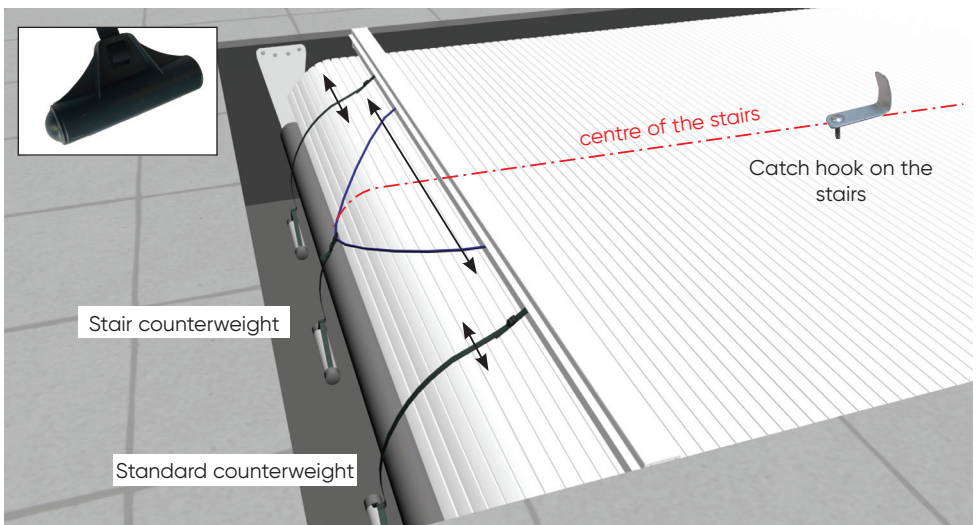

# INSTALLATION

## INSTALLATION OF THE COUNTERWEIGHTS



**Adjusting  
depth of  
counterweight**



10cm maximum

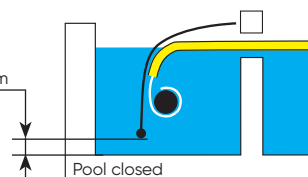
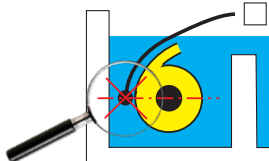

Pool closed

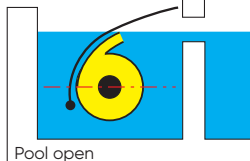

Pool open

## INSTALLING THE DECKING

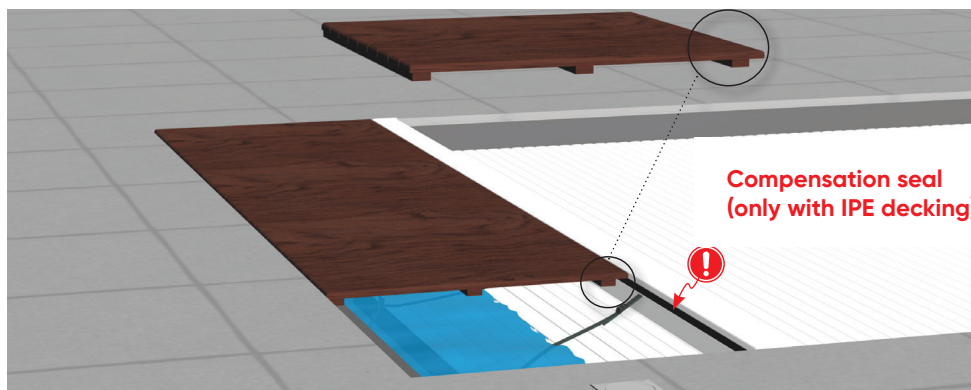

**Compensation seal  
(only with IPE decking)**

Dimensions must be determined in compliance with the applicable standard.

If the decking are not supplied by DEL, you are responsible for their compliance.

The use of decking that do not comply with the standard will de facto render the entirety of the installation non-compliant. In order for the duckboard to comply with standard NF P90-308, DEL recommends that the following instructions must be respected:

- The wood used must be Class 4 and have a minimum lifespan of 3 years, e.g.: Ipe, doussie, merbau, moabi, padauk, or robinia for wood that has not been treated and Scotch or maritime pine for treated wood.
- The minimum effort required to lift a duckboard must be 5kg. The minimum weight for each element must be 11kg. Failing this, the decking must be fastened into place or only removable by using a tool.
- The maximum space between the boards must be less than 7mm, in order to avoid anything being trapped between them.
- In order to prevent any risk of corrosion, the bolts should be made of A4 stainless steel or equivalent.

# INSTALLATION

## ELECTRICAL CONTROL BOX

### ➤ MOUNTING THE CONTROL BOX

- The control box must be fixed to the wall of the equipment room in an easily accessible position, between 1 metre and 1.80 metres above the floor.
- The box must be securely fixed to the wall using the screws and plugs supplied with it.
- Caution: if you decide to fix your enclosure by any other means, please ensure that it is securely fixed, as the guarantee may not apply. Please note that adhesives are not considered to be a reliable means of fixing.



**No warranty if box is drilled.  
If the enclosure is drilled, be sure to seal the fixings.  
Use the fixings supplied with the box to maintain the IP rating.**



# INSTALLATION

## CONTROL BOX

The electrical connection of the equipment must only be carried out by a qualified professional, and they must comply with the manufacturer's instructions in addition to the following applicable standards and regulations:

- NF C15-100: Low voltage electrical installations.
- CEI 60364: Electrical installations for buildings.

Please refer to the leaflet enclosed with the control box to ensure correct installation.



Incorrect installation may result in an electric shock, or it may damage the unit. We recommend that you disconnect the control box from the electricity supply prior to any work being carried out on it.

Any specific electrical supply line must be protected by a 30 mA of type F circuit breaker along with a sufficient overcurrent protection control box.

We recommend use of a shielded cable with a nominal cross-section that is not lower than the one indicated in the following table:

Current rating of unit A	Nominal cross-section mm <sup>2</sup>
≤ 0.2	Flat twin tinsel cord a
> 0.2 and ≤ 3	0.5 a
> 3 and ≤ 6	0.75
> 6 and ≤ 10	1.0 (0.75) b
> 10 and ≤ 16	1.5 (1.0) b
> 16 and ≤ 25	2.5
> 25 and ≤ 32	4
> 32 and ≤ 40	6
> 40 and ≤ 63	10

NOTE: For power cables supplied with poly-phase units, the nominal cross-section of the conductors is based on the maximum cross-section of the phase conductors at the end of the power cable that is intended to be connected to the terminals of the unit.

- a These cables can only be used if their length, as measured between the point where the cable or cable protector enters the equipment and the connection to the mains supply, does not exceed 2 m.
- b Cables that have the cross-section indicated in brackets can be used for mobile units if their length does not exceed 2 m.

# INSTALLATION

**!** Ensure that there is no-one in the pool when carrying out the operation.

## WIRING FOR AQUA1 CONTROL BOX WITH WI-KEY CONTROL

\*see comments and diagrams on page 25

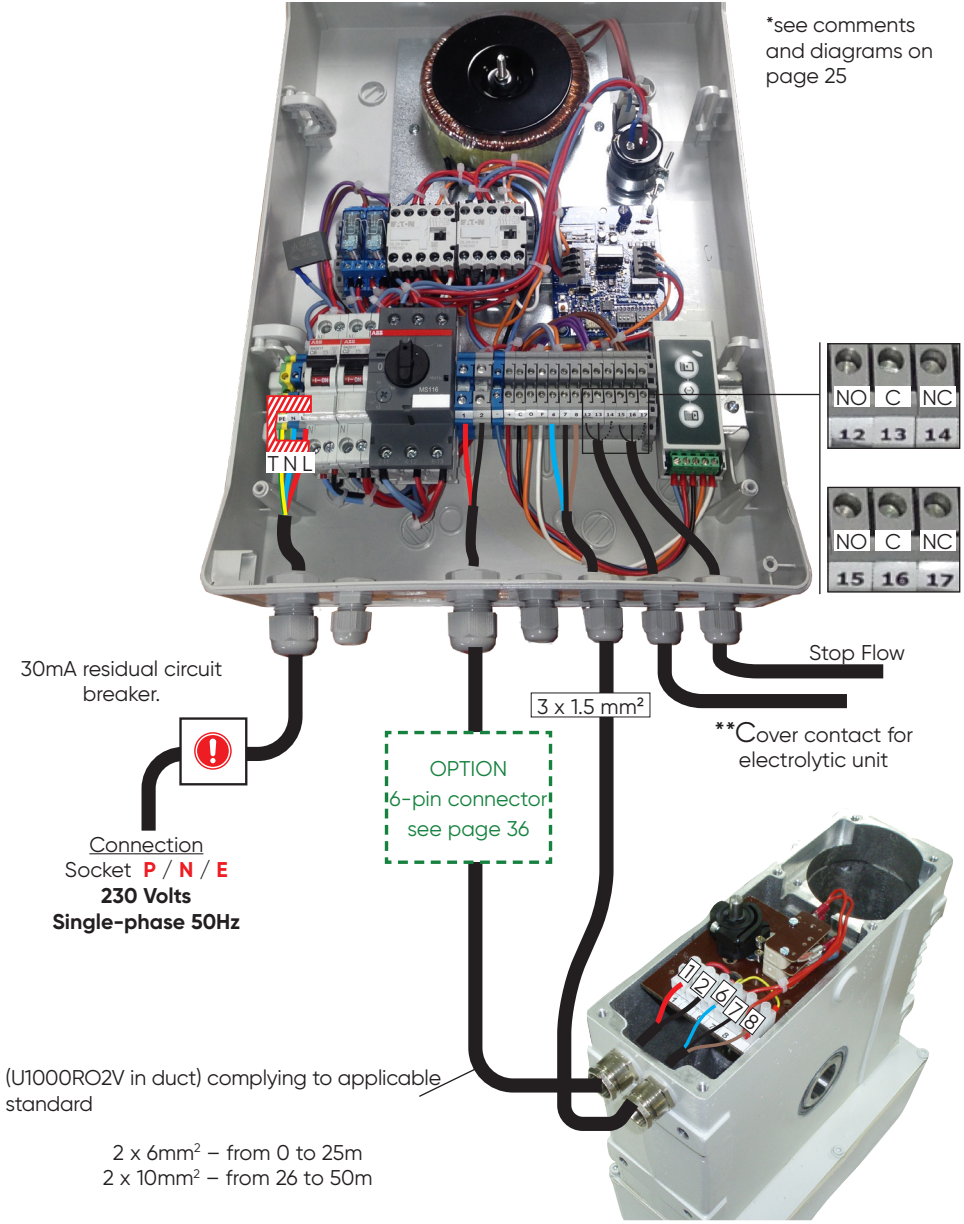

NO	C	NC
12	13	14

NO	C	NC
15	16	17

30mA residual circuit breaker.



Connection Socket **P / N / E**  
**230 Volts**  
**Single-phase 50Hz**

**OPTION**  
6-pin connector  
see page 36

Stop Flow

\*\*Cover contact for electrolytic unit

(U1000RO2V in duct) complying to applicable standard

2 x 6mm<sup>2</sup> – from 0 to 25m  
2 x 10mm<sup>2</sup> – from 26 to 50m

# INSTALLATION

## WIRING FOR AQUA1 CONTROL BOX WITH KEY SWITCH CONTROL

\*see comments and diagrams on page 25

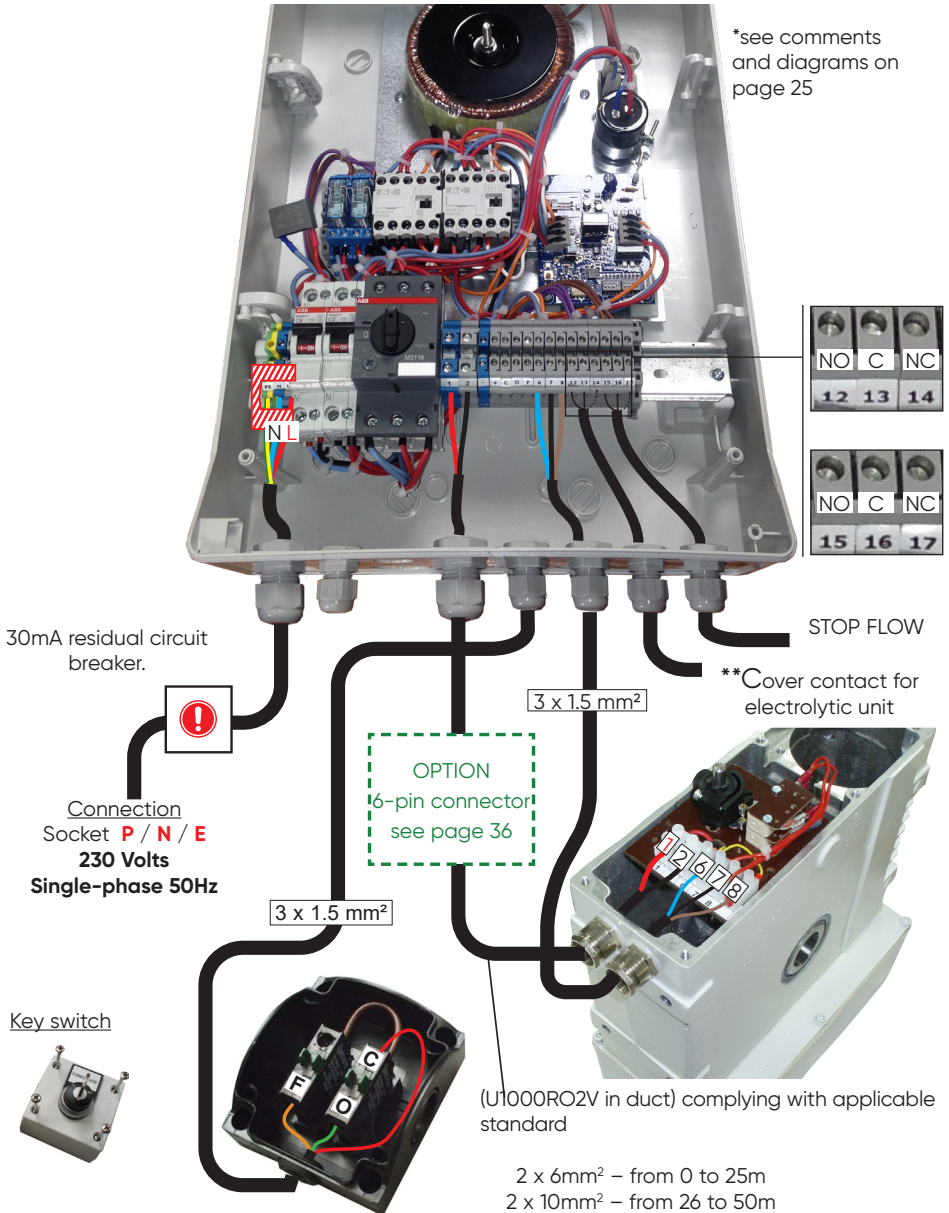

# INSTALLATION

## WIRING FOR MIT 5210-7210 CONTROL BOX WITH WI-KEY CONTROL

\*see comments and diagrams on page 25

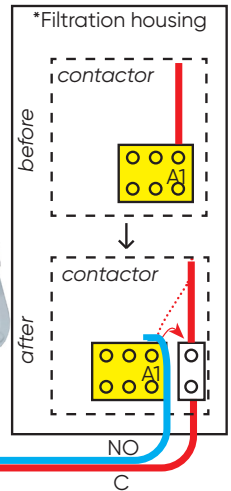
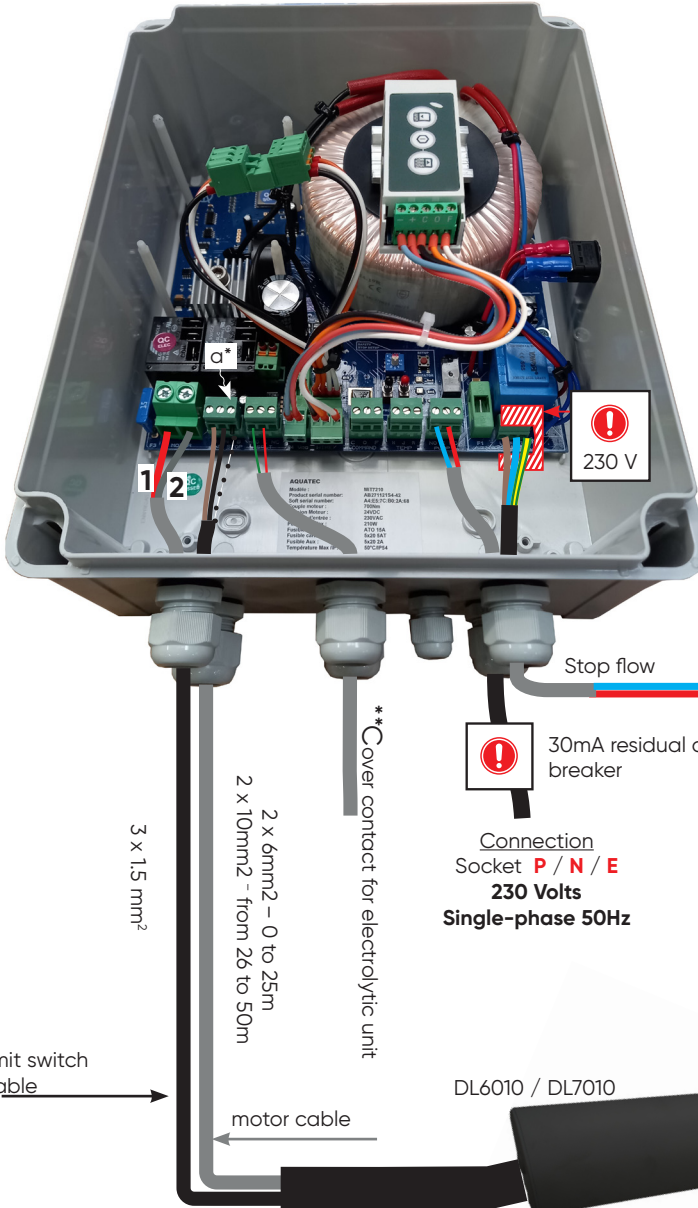

Stop flow

30mA residual circuit breaker

Connection  
Socket **P / N / E**  
**230 Volts**  
**Single-phase 50Hz**

DL6010 / DL7010

3 x 1.5 mm<sup>2</sup>

2 x 6mm<sup>2</sup> - 0 to 25m  
2 x 10mm<sup>2</sup> - from 26 to 50m

\*\*Cover contact for electrolytic unit

limit switch cable

motor cable



# INSTALLATION

\* "PUMP" terminal block Piloting the filtration pump.

When the cover is moving: Contact C-NO open (stop filtration) and contact C-NC closed (filtration).

BEFORE

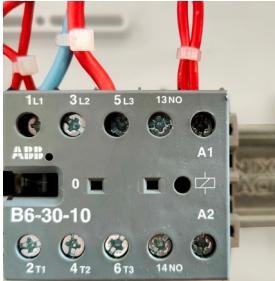

AFTER

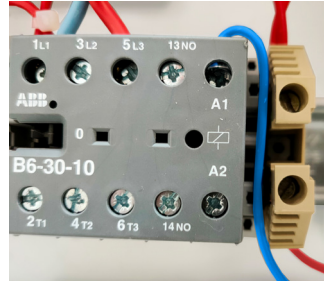

\*\* "SALT" terminal block electrolyser control

From 80% closed: Contact C-NO closed and contact C-NC open

From 20% open: Contact C-NO open and contact C-NC closed

The position of the dry contact is saved in the memory in case power to the control box is ever switched off.

a\* : ..... Wire may or may not be present according to the type of motor.



Its location must allow you to check that no-one has entered the pool during the operation.



**We advise you to put some waterproofing gel in the Junction box once the wiring is completed.**



# INSTALLATION

## WIRING FOR 6-PIN CONNECTOR – OPTION



The connector allows you to disconnect the geared motor very quickly, without any need to carry out any operations on the electrical wiring.

For Wintering, replace the geared motor with the Wintering lever.

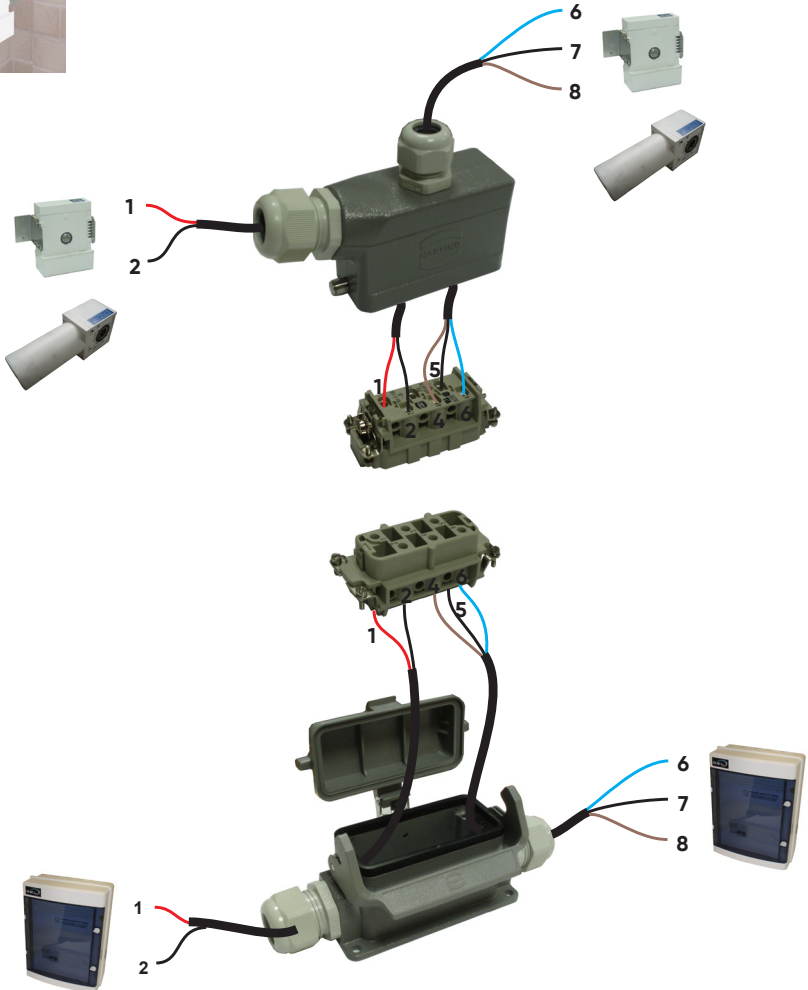



# INSTALLATION

## WI-KEY CONTROL



Flashing red/green = emitter locked  
See emitter unlocking procedure page 29

	 Receiver	 Emitter
Manufacturer	DEL	DEL
Reference	Wi-Key receiver	Wi-Key emitter
Category	3 (EN 300220-1)	2 (EN300220-1)
Range	50m open field range	50m open field range
	25m through a concrete wall	25m through a concrete wall
Power supply	12 to 48 Vcc 30mA max	2 batteries, 1.5V AAA
Protection rating	IP40	IP54

The emitter must be set outside of the volume 0 position (volume 0 is the part that is underwater, even if immersion is temporary).

The distance between the emitter and the receiver must not exceed:

- 50m open field range
- 25m behind a single wall
- 15m behind multiple walls or a particularly thick wall.

Frequency bands used by the emitter-receiver: 868MHz to 868.6MHz

Maximum power of the radiofrequency: 10mW

We advise you to check the emitter-receiver connection prior to fastening the elements into place.





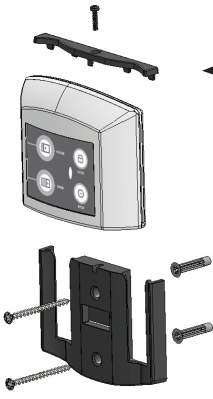

# INSTALLATION



- It must be located in a place that allows the operator to check that no-one is in the pool during the operation.
- It is compulsory for the locking "bar" to be installed and bolted into place.
- Before fastening the control box, ensure that the emitter is communicating with the receiver.

← The bracket must be fastened to a fixed base.

 CLOSE	 OPEN	 Lock keypad	 Stop current operation
----------------------------------------------------------------------------------------	----------------------------------------------------------------------------------------	-----------------------------------------------------------------------------------------------	----------------------------------------------------------------------------------------------------------

## CONNECT A NEW EMITTER

### Receiver

1

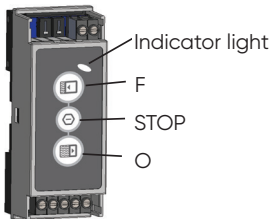

Press "STOP" and hold the switch down, then press "O" for more than 3 seconds OK when the "Indicator light" flashes green.

Connection of a new emitter must be carried out within the following 30 seconds.

# INSTALLATION

## Emitter

2



Press "STOP" and hold the switch down, then press "O" for more than 3 seconds OK when the "Indicator light" flashes red/green.

Connection of a new emitter must be carried out within the following 30 seconds.

### ▶ LOCK WI-KEY

- Hold  for more than 3 seconds until the indicator flashes







### ▶ UNLOCK WI-KEY

- Press  and hold
- At the same time: press successively on the following three switches:



- The  indicator light remains on  = **emitter unlocked**

	Green LED	--->	Wi-Key unlocked
	Flashing green/red LED	--->	Wi-Key locked
	Orange LED	--->	Battery level low
	Red LED	--->	Batteries need to be changed (2xLR03)

# INSTALLATION

## CALIBRATING THE LIMIT SWITCHES (MCA120-MCA250 MOTOR)

**!** Any person carrying out work on the electrical parts must be qualified and wear PPE (personal protective equipment): gloves, goggles, mat, etc...

### ▶ CHECKING THE POSITION OF THE LIMIT SWITCH CAMS

### ▶ UNSCREW THE CAM LOCKING BOLTS

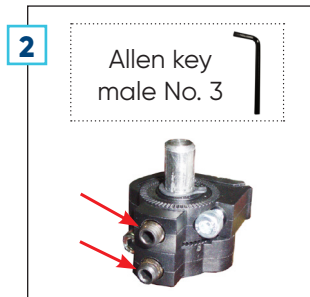
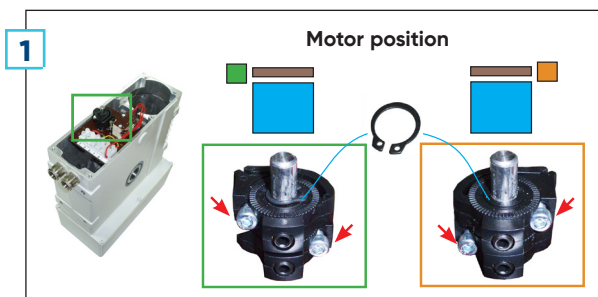

### ▶ DEACTIVATE THE AUTOMATIC SWITCH

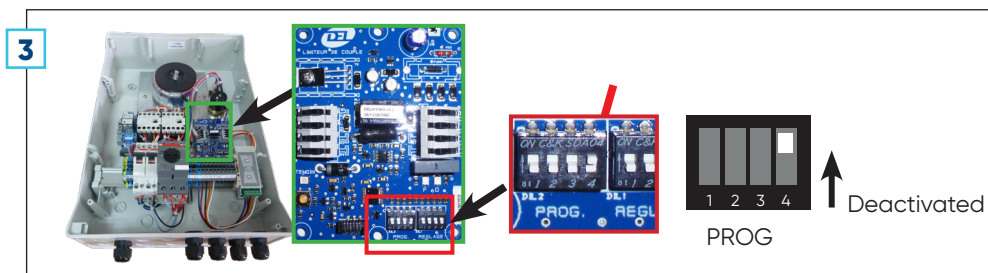

**!** Warning: use of the pool cover control switches present in the housing (Wi-Key receiver) must only be carried out by a person who is absolutely certain that there is no risk and that no-one will enter the pool during the operation.

# INSTALLATION

## ► VERIFICATION OF THE CONTROL LOGIC

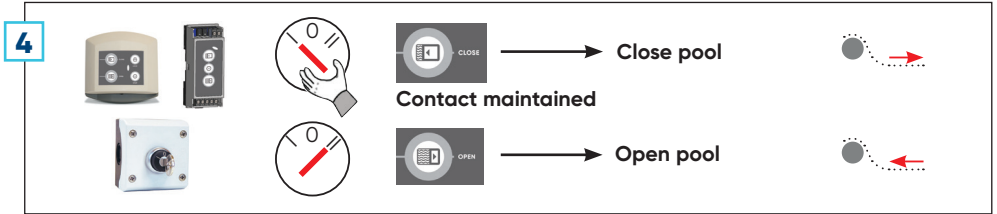

If the control logic is not respected, check the wiring of the installation.

## ► PUT THE COVER INTO THE "POOL OPEN" POSITION

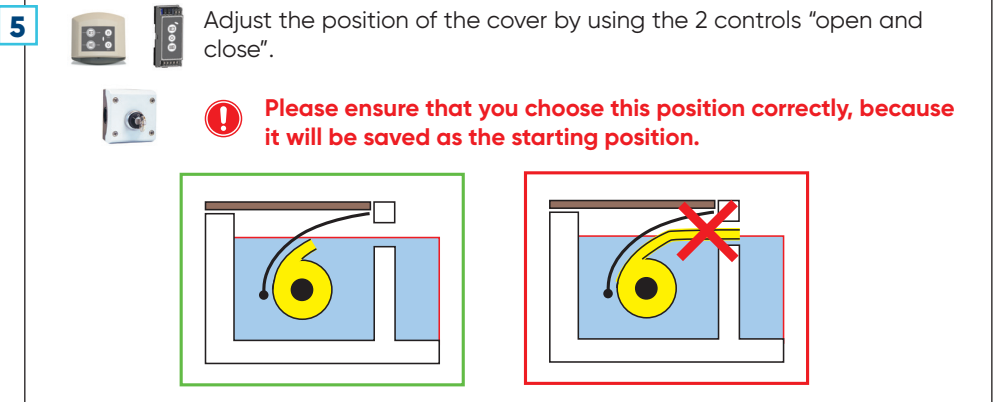

## ► MEMORISE THE "POOL OPEN" POSITION

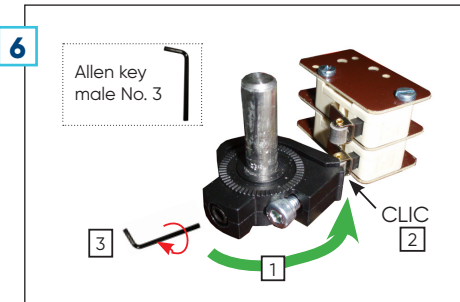

OR

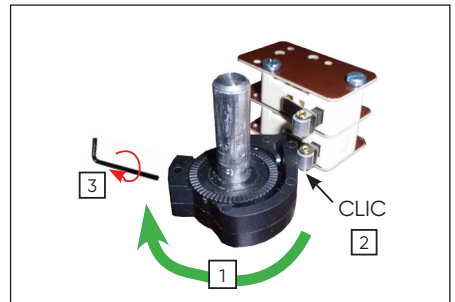

# INSTALLATION

## ▶ PUT THE COVER INTO "POOL CLOSED" POSITION

- 7**  Adjust the position of the cover by using the 2 controls "open and close".

**!** **Warning: the last control used must be to close the pool.**  
If the cover does not close, check the control logic and start the whole limit switch calibration procedure again.

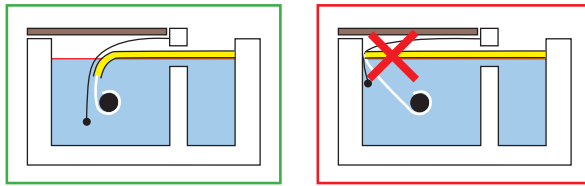

## ▶ MEMORISE THE "POOL CLOSED" POSITION

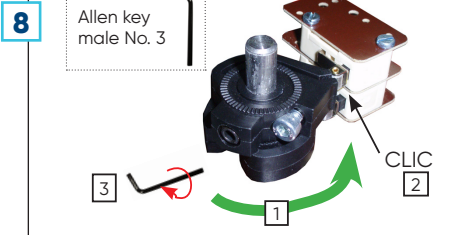

OR

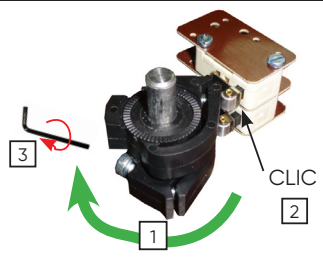

## ▶ ADJUSTING THE LIMIT SWITCH CALIBRATION

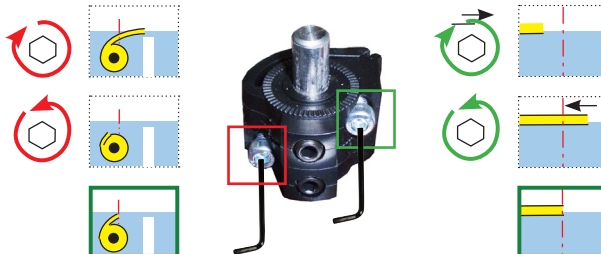

# INSTALLATION

## AUTOMATIC SWITCH (MCA120-MCA250 MOTOR)

The automatic switch protects the system from any potential oversights with regard to the unlocking of the fastening control boxes, when the pool is opened. If the cover is blocked, the motor will stop automatically.

### The different reasons for a blockage:

- Fastening control boxes have not been unlocked.
- The cover is scraping (on a beam, on the pool rim...).
- Presence of an object in the pool (robot, counterweight...) that is blocking the cover.

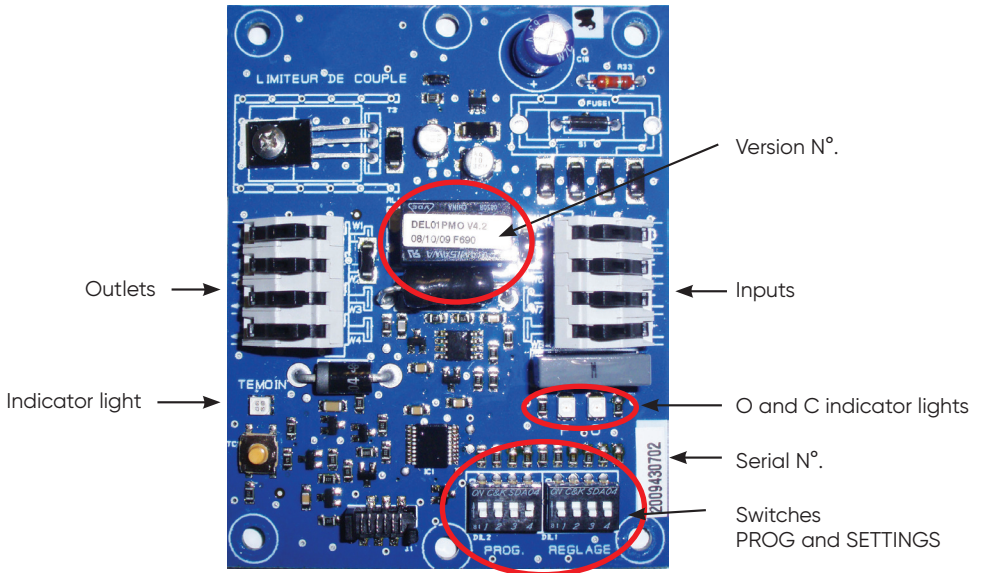

# INSTALLATION

## VERIFICATION OF THE CONTROL LOGIC FOR THE AUTOMATIC SWITCH

**!** Any person carrying out work on the electrical parts must be qualified and wear PPE (personal protective equipment): gloves, goggles, mat, etc...

### ▶ DEACTIVATING THE AUTOMATIC SWITCH

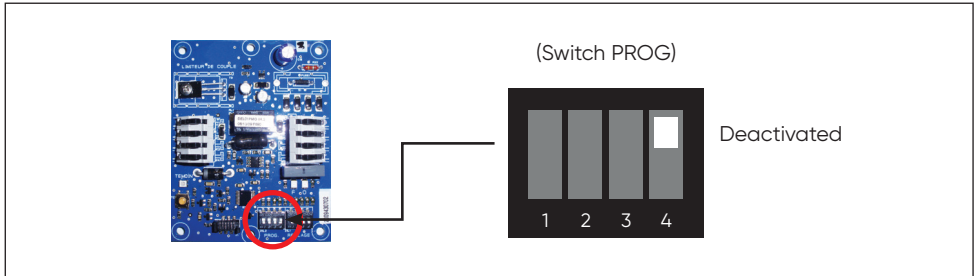

### ▶ CHECK WIRING

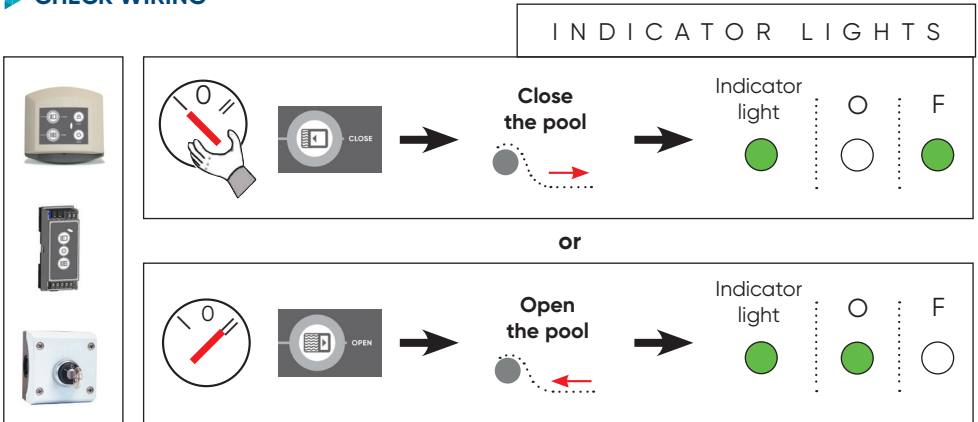

**!** If the control logic is not respected, check the wiring of the installation.

# INSTALLATION

## REWINDER MODEL CALIBRATION (SETTINGS SWITCH)



## CONTROL PERIOD CALIBRATION (SETTINGS SWITCH)

L = pool length including stairs

$L \leq 12$  m



30 seconds

$L > 12$  m



60 seconds



## TRIGGERING SENSITIVITY CALIBRATION (PROG SWITCH)

l = pool width



$l \leq 3$  m



$l \leq 4$  m



$l \leq 5$  m



$l \leq 6$  m



$l \leq 7$  m



$l \leq 8$  m



$l \leq 9$  m



$l \leq 10$  m



Maximum sensitivity

Minimum sensitivity

## ACTIVATION (PROG SWITCH)



Failure to activate the automatic switch can cause serious damage to the motor, the control box and the slats, which will affect the warranty.



Activated





# INSTALLATION

## IMPORTANT

**Contact maintained for more than 3 secs**

=

The next opening will be protected



**more than 3 secs**



**Contact maintained for less than 3 secs**

=

The next opening will not be protected



**less than 3 secs**



## TEST

**A** - Block the cover manually or use the fastening equipment, and open the pool.

=> **The motor is stopped automatically**  
(if required, adjust the triggering sensitivity setting)

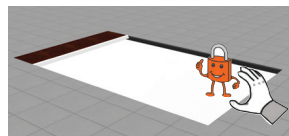

Card activated		Indicator light	O	F
	Opening, check underway			
	Open without check			
	Close			
	Protection triggered			

**!** If you notice that triggering is occurring at random times, reduce the triggering sensitivity by increasing the setting to one designed for a wider pool.

# INSTALLATION

- ❗ Any person carrying out work on the electrical parts must be qualified and wear PPE (personal protective equipment): gloves, goggles, mat, etc...
- ❗ Warning: use of the pool cover control switches present in the housing (Wi-Key receiver) must only be carried out by a person who is absolutely certain that there is no risk and that no-one will enter the pool during the operation.

## CALIBRATION OF LIMIT SWITCHES (MIT5210 - MIT7210 MOTOR)

### ▶ VERIFY

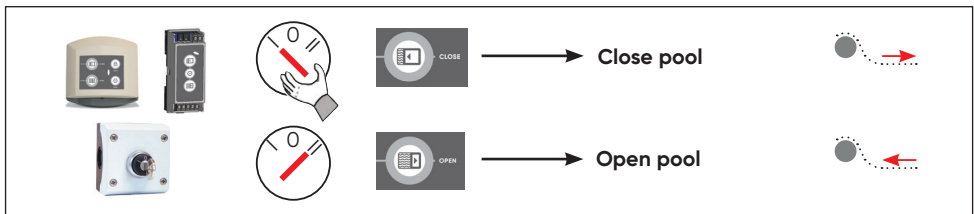

If the control logic is not respected, check the wiring of the installation.

### ▶ PROGRAMMING THE LIMIT SWITCHES

1. To memorise the starting position reference, place the cover in the open position. Use forced mode if required by setting the "FORCED" switch to ON.
2. Set the "FORCED" switch back to OFF.
3. Set the "PROG" switch to ON.
4. Unroll the cover while holding the switch in the "Close" position (if the motor does not start, the "DEFAULT" indicator light (red LED) is not lit and the switch wiring is correct, invert the motor wires).
5. Release the switch once the pool is fully covered.
6. If required, go back (switch to Open position), this absolutely must then be followed by closing the pool.
7. Set the "PROG" switch to "OFF".

## SERVICING/MAINTENANCE

**Any person carrying out work on the electrical parts must be qualified and they must comply with the manufacturer's instructions in addition to the applicable standards and regulations.**



**During any intervention, the technician must wear PPE (personal protective equipment): gloves, goggles, mat, etc...**

**We recommend that the installation be disconnected from the power prior to any intervention taking place.**

### WATER LEVEL IN POOL

- In order to ensure maximum safety and correct operation of the rewinder, always check that the water level in the pool remains constant and complies with the manufacturer's requirements (for greater comfort, use an overflow and a water level regulator).
- A water level that is too high is due to the overflow being obstructed by leaves or other items.
- A water level that is too low means that there is a risk of blockage.
- In case of a recess or a handrail, the water level must be controlled by a level regulator.

### WATER FILTRATION AND TREATMENT

- Programme filtration to take place at a time when the sun is shining on the pool and ensure that it is set to work all the time when the water reaches 25°C.
- In order to ensure that your installation will last, the water in the pool must be correctly treated in compliance with the applicable standards and recommendations (NF EN 16713-3).
- The pH, hardness and alkali levels of the water must be checked and adjusted as often as is necessary (although you will need to ensure that you don't correct these three parameters independently of each other but do so using the Taylor table and provide the water with balance with regard to the three parameters analysed).

### CARE (responsibility of the customer)

- Clean your slatted cover thoroughly twice a year (when opening the pool for the season and when winterising it). This is even more important if your pool water is hard. To do this, use a descaling cleaner (see catalogue) and rinse with a water spray.
- Inspect the entire system if an abnormal load is placed on the cover (such as in the event of a fall).
- Inspect the straps annually.
- Do not wash IPE duckboard with a high pressure washer, we recommend washing them regularly with clean water and a non metallic brush.
- Do not run, walk with care, the surface of the gratings can be made slippery by poor maintenance.
- Take care to clean the gratings regularly so that their surfaces do not become slippery.
- If the gratings become slippery, remove them and clean them mechanically.
- Cleaning and maintenance by the user must not be carried out by unsupervised children.

# SERVICING/MAINTENANCE

## MAINTENANCE (ONCE PER YEAR MINIMUM)

- All interventions must be carried out by a professional, who will contact the manufacturer if necessary (contact details on the back page of this document).
- All spare parts must come from the manufacturer or comply with standard NF P90-308.
- Check that the installation is working correctly.
- Inspect the cover thoroughly.
- It is necessary to check at the start of every season and if any accident has occurred (if anything has fallen onto the cover, if hail has struck the cover, if the cover has had to bear any abnormal weight etc...) ensure that none of the slats has sustained any visible damage that may affect the safety of the cover (cracked slats, holes, deformations, etc...). Make sure that you change the slats or the entire cover if required.
- In winter as in summer, do not place an opaque sheet over the cover: this may damage the slats due to high temperatures.
- Check the state of the straps (seams) and in particular the wear on the anti-abrasion sleeve. If the latter is no longer fulfilling its role of protecting the strap against abrasions from the pool rim, then replace it.
- Once a year, check that the electrical connections are sufficiently tight.
- Customer service: contact details on back page of document

# MAINTENANCE

## WINTERING CRANK – OPTION

Aim: to allow the motor to overwinter while ensuring that the pool is safe.

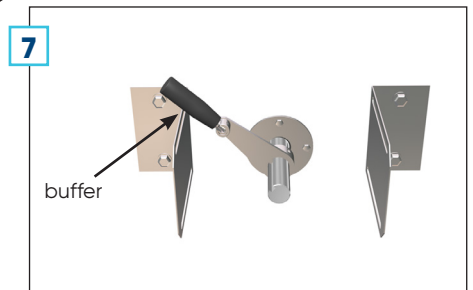
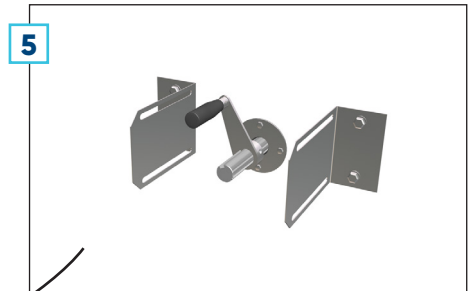
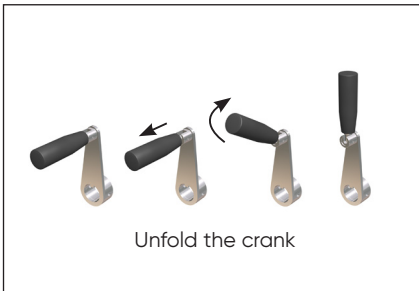
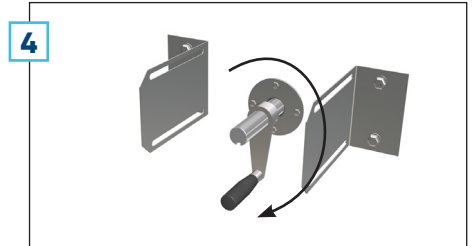
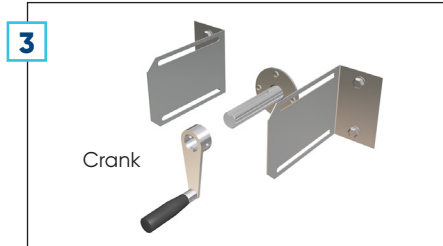
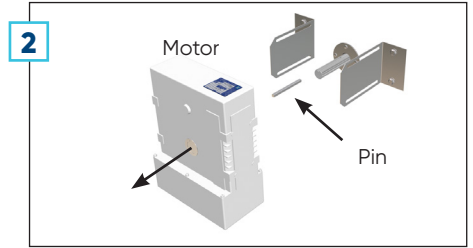
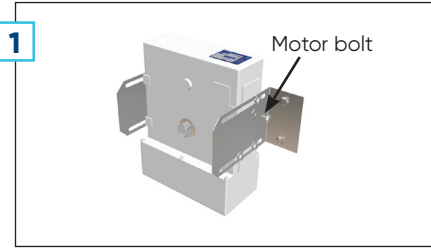

# SERVICING/MAINTENANCE

## WINTERING

- Position the cover in the closed position and keep the water level constant in accordance with the manufacturer's recommendations.

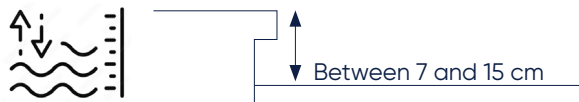

- During the winter season, in the event of snowfall, it is essential to remove snow from the roof using a brush with a telescopic handle.
- Snow should be removed from the cover using a blunt tool (such as a synthetic floor brush or broom).
- Winterise the pool according to its geographical location.
- Close the cover in the safety position.
- Leave the batteries connected to the reel and do not cover the solar panel.
- We recommend installing an Ivernéa winter cover or an Ivernéa Plus protective cover to protect the cover from UV rays and dirt.

## SPARE PARTS

Online catalogue :



<https://www.my-cfgroup.fr/fr/pieces-detachees>

## SAFETY ADVICE

Dear Customers,

Thank you for placing your trust in us by selecting a safety cover made by DEL.

Please read the recommendations set out below with care.

### WARNING

**Swimming pools can represent a serious danger for your children. Drowning can happen very quickly.**

**Children who are close to a swimming pool need to be watched constantly and actively, even if they know how to swim.**

**Learn lifesaving skills.**

**The physical presence of an adult is absolutely essential whenever the pool is open.**



Memorise the telephone numbers for the emergency services and ensure that they are displayed close to the pool.

**☎ 18 (in France) or 112**

**FIRE SERVICE**

**☎ 15**

**AMBULANCE  
SERVICE**

(write the number that applies in your region)



**POISON CONTROL  
CENTRE**



## SAFETY ADVICE

- This section is by no means a replacement for common sense or individual responsibility. Its aim is not to replace the vigilance of parents and/or responsible adults, who remain the essential factor in ensuring the protection of young children.
- **Warning:** safety is only guaranteed when the cover is closed, locked and correctly installed in compliance with the manufacturer's instructions.
- The cover must systematically be closed if you are absent from home, even for a very short period.
- Check that no persons and no foreign objects are in the pool before and during opening and closing operations.
- Make sure that you place all of the tools required for moving the pool cover out of the reach of children (e.g. the key).
- The operation of the mechanism must only be carried out by a responsible adult.
- Climbing, walking or jumping on a pool cover is strictly forbidden.
- Take all necessary measures to prevent access to the pool for young children until the cover is repaired or when a malfunction is observed that prevents closing or in case of temporary unavailability of the equipment or the pool.
- Respect the water levels designated by the manufacturer.

A child can drown in less than 3 minutes, no type of protection can ever replace the watchful eye and vigilance of a responsible adult.

# RECYCLING

## PACKAGING

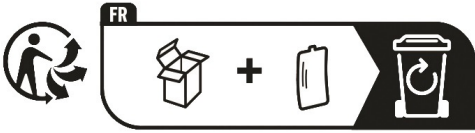

Dispose of the packaging in line with current rules and regulations.

## END OF LIFECYCLE



- Do not put your scrapped equipment or used batteries in with unsorted household waste.
- You are responsible for disposing of all of your waste, in particular electrical and electronic equipment by taking it to a collection point where recycling and valorisation are carried out.
- Certain products potentially contain substances that are dangerous for the environment, and you need to ensure that these are eliminated or neutralised.
- Make sure that you are aware of all existing recovery and collection systems.



discard the manual in line with the current regulations.



Adresses sur [quefairedemesdechets.fr](http://quefairedemesdechets.fr)

## REGULATIONS

### STANDARD

- This cover complies with standard NF P90-308.

### WARRANTY CONDITION

log on to [www.del-piscine.fr](http://www.del-piscine.fr) to consult all our guarantees.



<https://www.del-piscine.fr/rechercher-une-garantie>

**DEL SAS**  
ZA LA BASSE CROIX ROUGE  
35530 BRÉCÉ - FRANCE

☎ +33 (0)2 99 00 17 72

STAMP

A brand by CF group



ORIGINAL INSTRUCTIONS

A-DOTE03505.L1 / 05 2023